

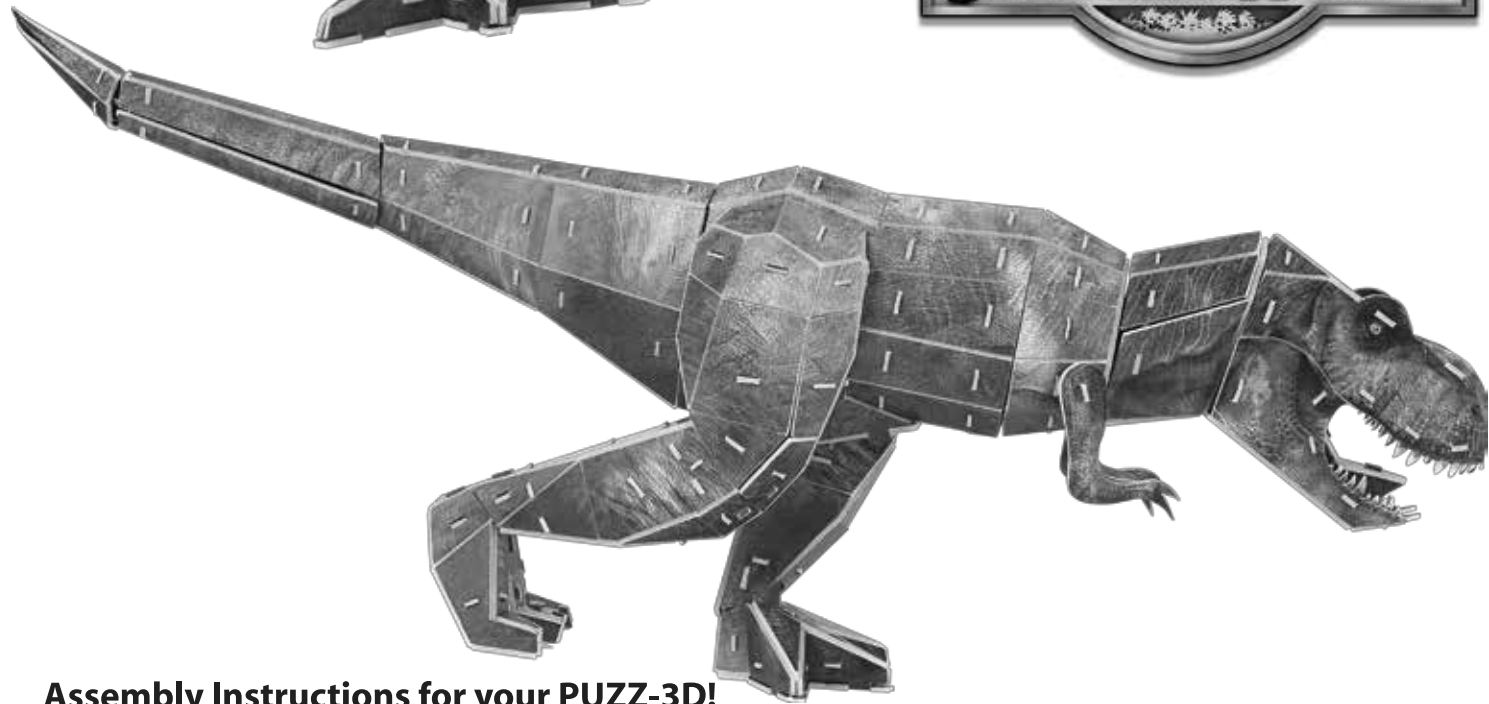

PUZZ 3D



Assembly Instructions for your PUZZ-3D!

Refer to the photograph on the package and join the pieces by matching the drawings on the above. After popping out the pieces, you can punch out the interlocking holes with the corners of the foam boards.

<Caution>

Please put the small leftover pieces into the garbage after finishing assembly.

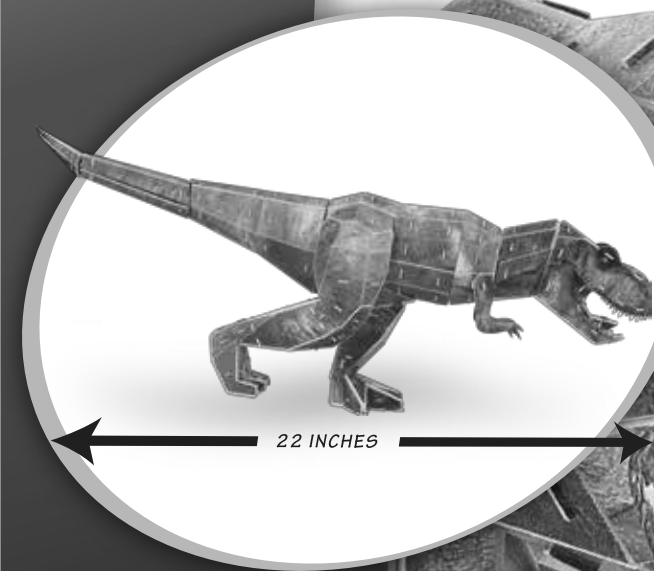

22 inches x 7 inches x 4 inches
(55.9 cm x 17.8 cm x 10.2 cm)



T-REX

3D FOAM BACKED PUZZLE
AGES 8+

80

BUILD YOUR OWN
T-REX
3D PUZZLE

Instructions

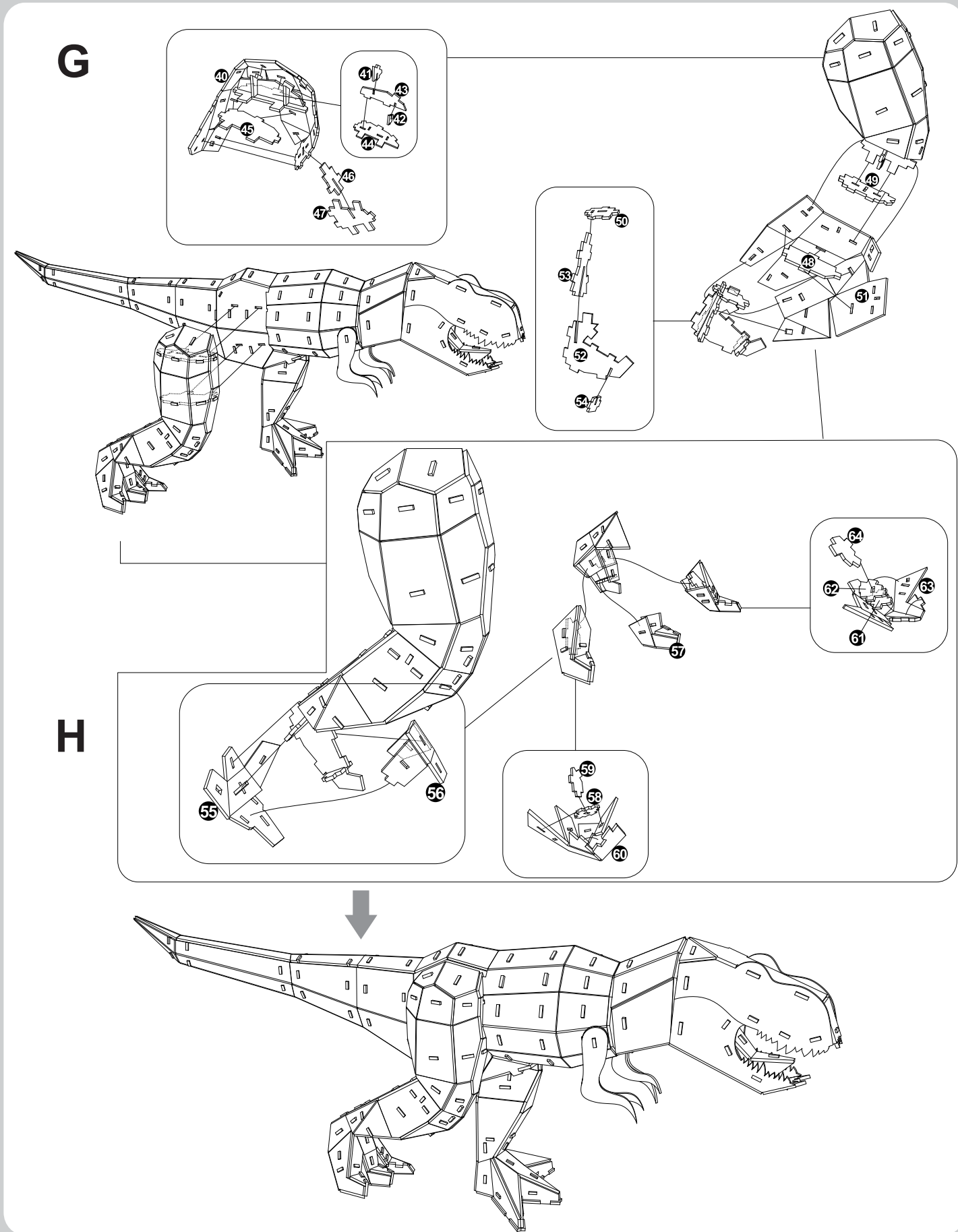
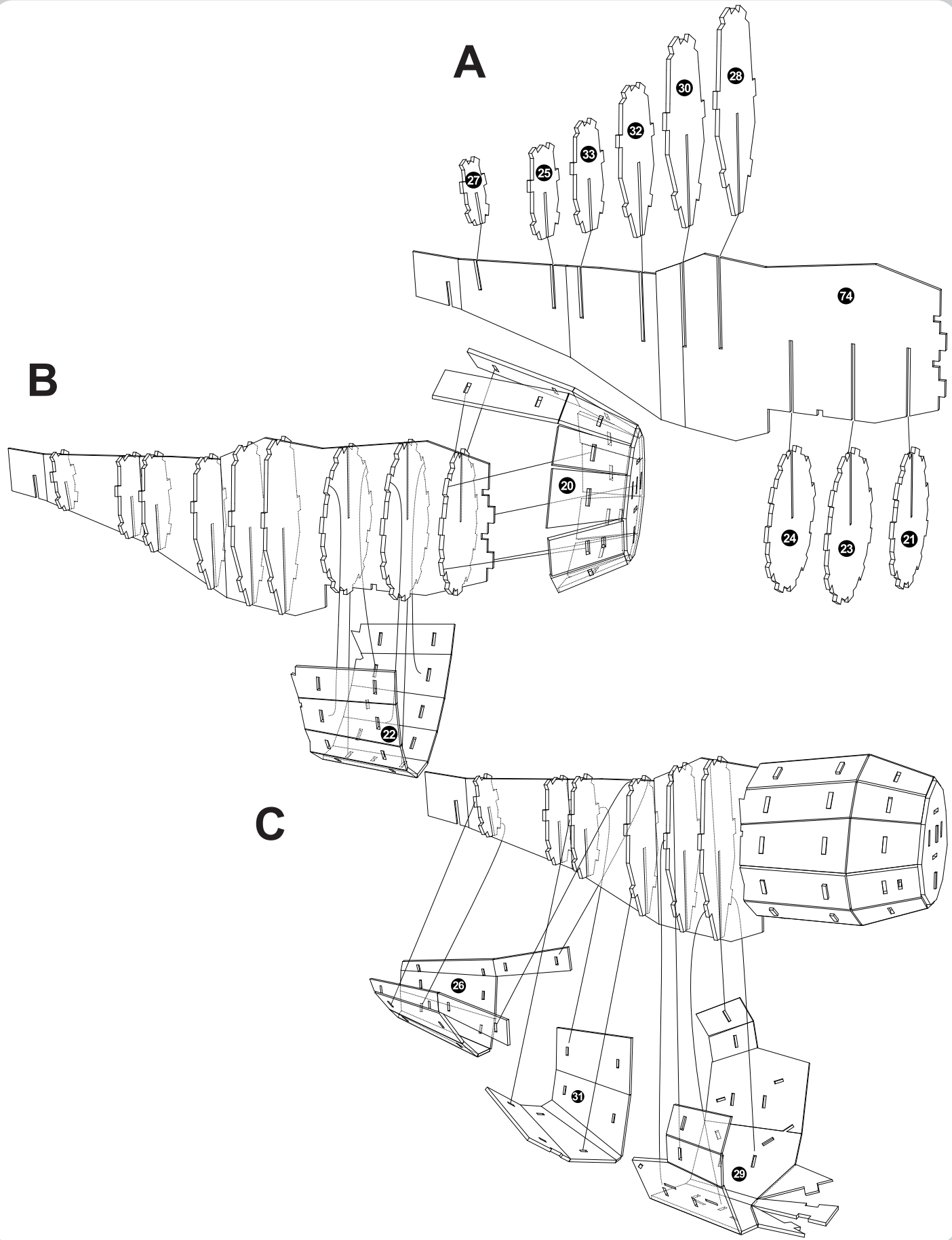

D

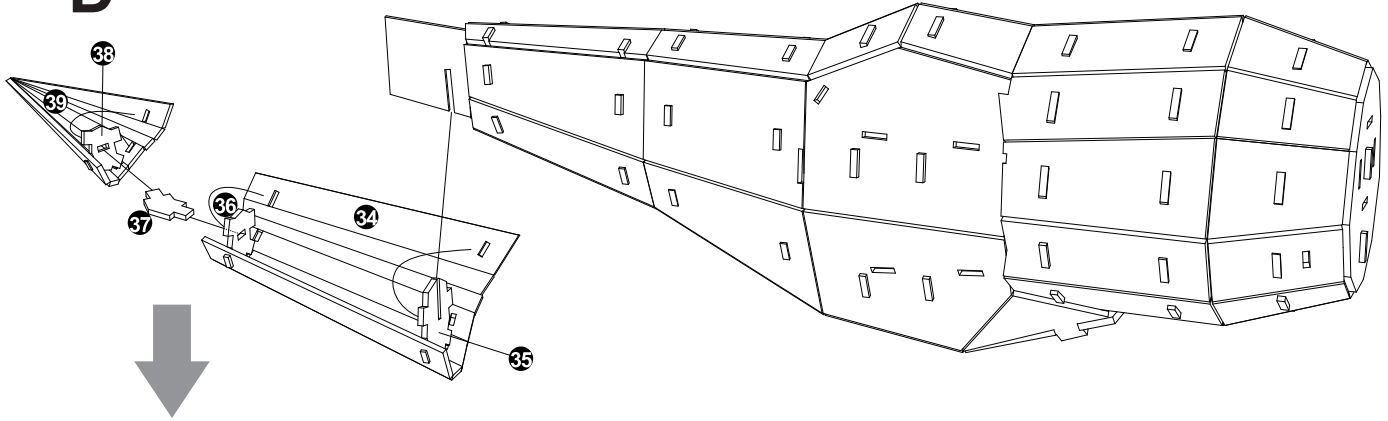

E

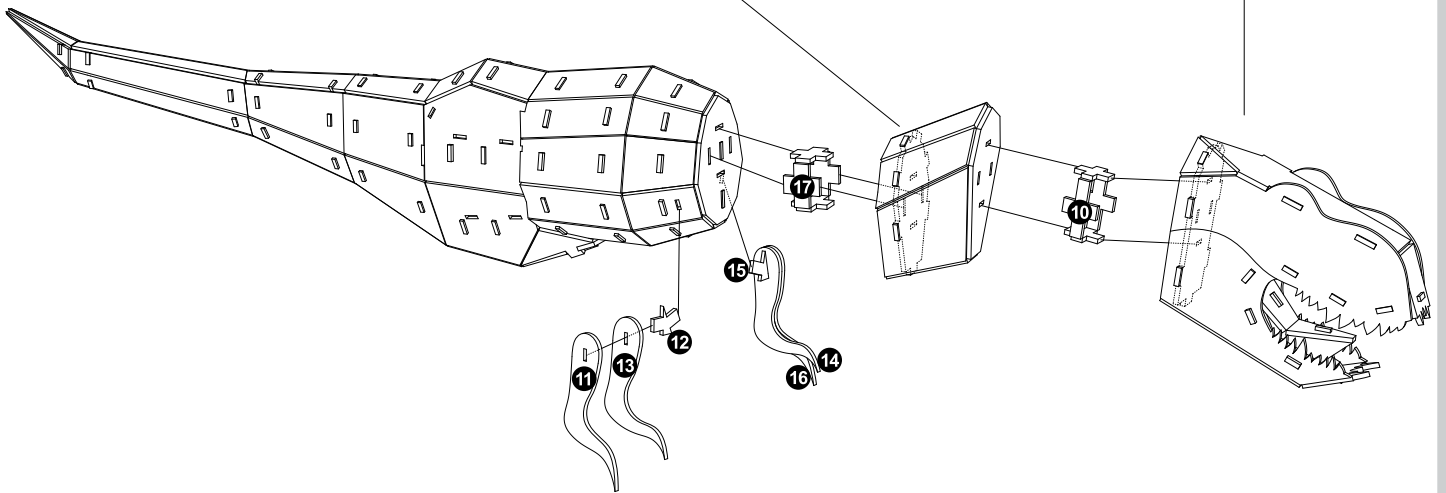
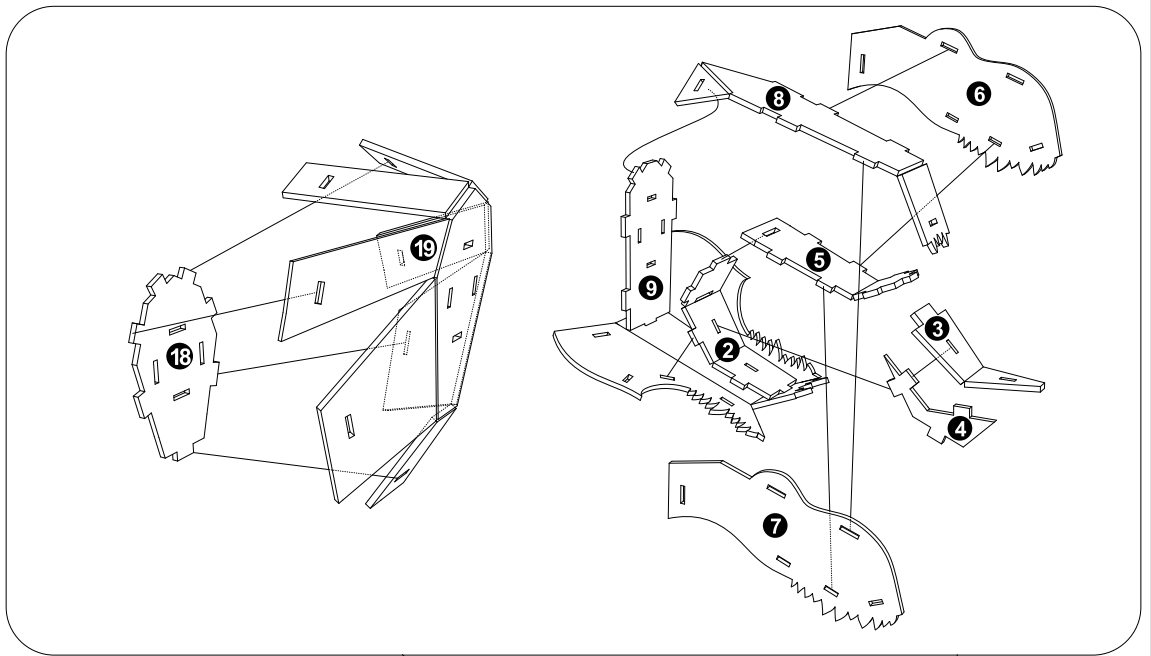

F

